

Operating instructions

Solar Ball 20, 30, 40 and 50 cm multi color



Customer support:

If you have problems or questions regarding this product, simply contact us!
Monday to Friday 9 am to 12 noon and 1 pm to 4 pm.
By phone: +49 9605-92206-0
By e-mail for ordering spare parts: ersatzteil@esotec.de
By e-mail for questions about the product: technik@esotec.de
Product: Manufacturer Item No.: 102609, 102610, 102611 and 102612

These instructions relate **ONLY** to this product and contain important information for using the product for the first time. Please keep these instructions for later reference and should always accompany the product in the event of transference to a new user.

1. Introduction

Dear Customer,
Thank you for purchasing the solar light.
With this solar light you purchased a product manufactured according to the current state of technology.



This product fulfils all requirements of the valid European and national regulations. The conformity was proved. The relevant declarations and documentation are deposited with the manufacturer.

To maintain this state and guarantee a safe operation, you as the user will have to follow this operating manual!

2. Safety Instructions



- In case of damages caused by not following this operating manual, the warranty rights will expire! We exclude liability for any consequential damages!
- We exclude liability for property or personal damages caused by inappropriate handling or not following the safety instructions.
- In these cases any guarantee rights will expire.

Due to safety and admission reasons (CE) it is not allowed to arbitrarily reconstruct and/or change the solar light.

Therefore, please keep to the operating manual. The accident prevention rules of the association of the industrial trade cooperative association for electric plants and working material are to be considered in industrial environments

3. Usage in Accordance with Requirements

The solar light is designed for the all-season outdoor use. It may e.g. be placed on patios, gardens etc.

The solar ball never swim on the water surface or stand in the water!

The integrated rechargeable battery is charged by a solar cell inside the light. The lamp is automatically switched on at darkness and switched out at the break of dawn. A powerful RGB and white light emitting diode (LED) is used as light source. The color of light gently changes every minute or may be fixed at the user's convenience.

-- Please note that the length of time that light is emitted is affected during the winter months and when there is little sunlight falling upon the solar module.--

Note: During prolonged periods without any incident solar radiation, the rechargeable battery will be insufficiently charged to ensure that the lamp is always ready for use. **This does not however mean that the solar lamp is defective.** Wait for the next sunny days and the lamp will again work correspondingly well. Alternatively you can recharge the battery in the intervening time by using a commercially available charger.

4. Putting into operation

1. Please carefully take the light out of the package.

2. Press the switch „ON/ OFF“ (pic. 1).

3. The light is in first use normally in a light changing mode. The 7 luminous colors are gently changed in an interval of approx. 1 minute. In order to fix the luminous color please simply press the button „STOP/Change“ (pic. 1).
In order to return to the changing mode, simply press the button „STOP/CHANGE“ again.

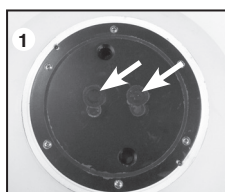

4. The light may be anchored in the ground by means of the enclosed ground spikes.

The solar light is now activated and ready for use!

Note: the duration of the light given out is highly dependent on both the intensity and the length of sunlight experienced during the day. On days when there is little sun then the light can normally be expected to be given out for a shorter period of time. Should the lamp still not light on the first evening, then wait until a sunny day or else charge the rechargeable battery using a commercially available charger.

5. Exchange of the rechargeable battery

On average, batteries of solar lights have to be exchanged every two years. Please only insert identical in construction batteries with identical voltage and capacity. In case you should not be able to get those batteries in the shops, you may also use batteries with a higher capacity.

1. Press the switch „ON/OFF“ on the bottom side of the ball and switch it off (pic. 2).
2. Unscrew the screws on the bottom part with an adequate screwdriver (pic. 2) and remove the lid (pic. 3).
3. Remove the battery from the bracket and replace it by a new freshly charged battery of identical size (Mignon, AA) (pic. 4).
4. Reattach the lid correctly and screw the screws back in with an adequate screwdriver.

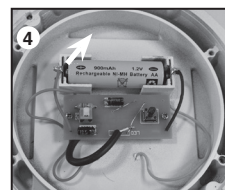
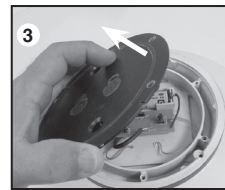

Note: In doing so, please make sure that the lid is applied correctly!

Note: used batteries must be disposed of in an environmentally friendly manner and should not be placed in your household waste. Your dealer is obliged by law to take back the old rechargeable batteries.

6. Malfunctions

-Lamp is not automatically switched on at darkness

- An outside light source (e.g. streetlight) simulates daylight and prevents the lamp from switching on. Place the lamp at a darker location.

- Lamp is not switched on at darkness or only for a short period of time.

- Is the lamp connected? (see point 4.4)

- Accumulator weak or defective. Exchange of the accumulators.

7. Technical details

- Solar module: 20 cm and 30 cm: crystalline silicium 0,5 Wp
40 cm: crystalline silicium 0,64 Wp
50 cm: crystalline silicium 1,5 Wp
- Means of illumination: 1 RGB + 1 white LED (6500 K) cold white
- Lighting color: 7 different
- Rechargeable battery: 20 and 30 cm: NiMH 1.2 V/900 mAh (Mignon, AA-size)
40 cm: NiMH 1.2 V/1300 mAh (Mignon, AA-size)
50 cm: NiMH 1.2 V/1800 mAh (Mignon, AA-size)
- Protection grade: IP 44
- Protection class: III
- Period of illumination: maximum 8 hours on a fully charged battery

Battery Recycling:

- Used batteries or accumulators must be disposed in the domestic waste.
- The consumer is legally obliged to bring back old accumulators upon usage, e.g. to public waste collecting locations or to the place (shops, etc.) where those batteries are sold.
- Batteries that contain harmful substances are marked with the "strike through dustbin" and one of the chemical symbols.

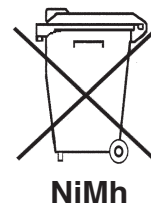

Rechargeable battery notes

- Rechargeable batteries should not be played with by children. Never leave rechargeable batteries lying around; they could be swallowed by children or pets.
- Rechargeable batteries must never be short-circuited, disassembled or thrown into fire. This leads to a danger of explosion!
- Leaking or damaged rechargeable batteries can cause chemical burns when they come into contact with skin. For this reason, please make use of suitable protective gloves.
- Rechargeable batteries should only be replaced by structurally identical rechargeable batteries from the same manufacturer. Normal batteries must not be used since these are not rechargeable.
- Make sure the rechargeable batteries are inserted with the correct polarity.
- For long periods of time of non-use (for example, storage), remove the inserted rechargeable batteries to avoid damages via the leaking rechargeable batteries.

Manufacturer/Importer:

esotec GmbH - Gewerbegebiet Weberschlag 9 - D-92729 Weiherhammer
Tel.-Nr: +49 9605-92206-0 - Fax.-Nr: +49 9605-92206-10 - Internet: www.esotec.de

Disposal:

Dear customer,
please cooperate in avoiding waste. When you intend to dispose of the product in future, please consider that it contains valuable raw materials suited for recycling.
Therefore, do not dispose it of with domestic waste but bring it to a collection point for the recycling of waste electrical and electronic equipment.

Thank you very much for your cooperation!
Copyright, esotec GmbH

